



Roman Way, Paulton. BS39 7XB

Guide Price £279,950

- Energy Rating - D
- South Facing Enclosed Rear Garden
- 3D INTERACTIVE TOUR
- Log Burner
- Beautifully Presented Throughout
- Parking For Two Large Vehicles
- Close Commuting Distance To Bath
- Outhouse/Bar

*****3D INTERACTIVE TOUR AVAILABLE*****BARONS welcome to the market this beautifully presented three bed terrace in Paulton. Close commuting distance to the City Of Bath and all local amenities including pubs, restaurants, shops, schools, a hospital and a swimming etc. The property comprises a light and airy living room with log burner, kitchen/diner and a outhouse, currently use as an entertainment area. On the first floor you are greeted with two double bedrooms, a single and a family bathroom. Call Barons today on 01761 411411 to arrange your viewing.

Living Room 13'8 x 11'5 (4.17m x 3.48m)

Kitchen/Diner 15'10 x 10'6 (4.83m x 3.20m)

Lean To Conservatory 16'11 x 7'1 (5.16m x 2.16m)

Bedroom One 15'7 x 8'10 (4.75m x 2.69m)

Bedroom Two 9'4 x 8'10 (2.84m x 2.69m)

Bedroom Three 6'9 x 6'2 (2.06m x 1.88m)

Bathroom 6'3 x 6'2 (1.91m x 1.88m)

Please Note

Tenure - Freehold

Council Tax Band - C

Council Tax Band - C





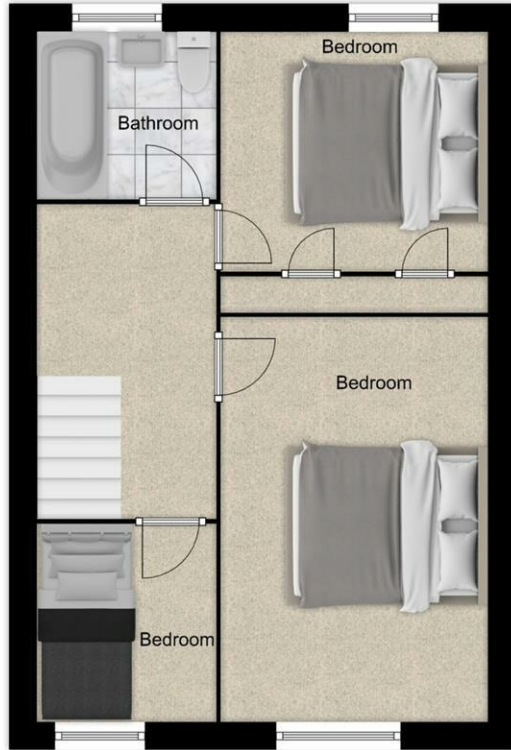

© Greenwood's Barons Property Centre 2022

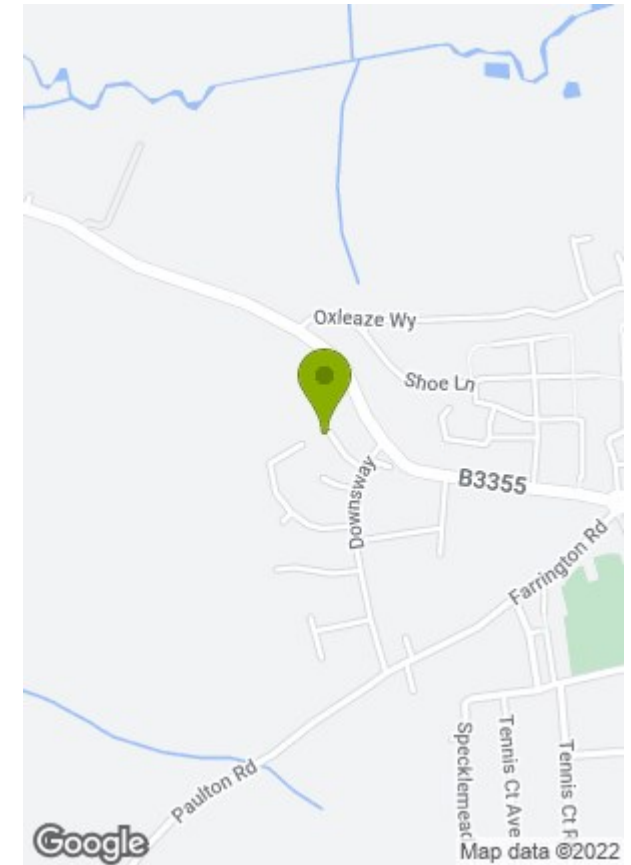

Energy Efficiency Rating

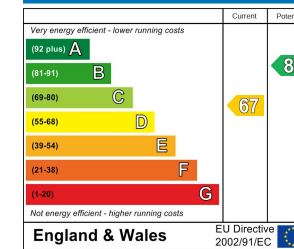

Environmental Impact (CO₂) Rating

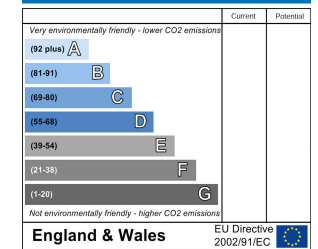

These particulars, whilst believed to be accurate are set out as a general outline only for guidance and do not constitute any part of an offer or contract. Intending purchasers should not rely on them as statements of representation of fact, but must satisfy themselves by inspection or otherwise as to their accuracy. No person in this firm's employment has the authority to make or give any representation or warranty in respect of the property.